

KIMANA is the new hinge conceived by Italiana Ferramenta to open and close drop-down doors. Provided with a unique and exclusive movement, it allows to open doors even when the bottom lies upon another panel.

The small dimensions ($\varnothing 26$ mm boring for both the door and the bottom) and minimalistic and elegant design contribute to make **KIMANA** not only a functional hinge, but also a product unique in its genre.

KIMANA can be easily adjusted through the screws (PZ2) which are hidden underneath the cover.

The fixing screws are perpendicular, thus making **KIMANA** suitable for aluminium profiles. Various door and bottom thickness-combinations can be solutioned as **KIMANA** allows the the ideal movement and alignment of the door.

PAT. PENDING

REGISTERED DESIGN

Part. no	Description	Finish
40115000YA	Plate for Kimana	Nickel-plated
40115010YA	Kimana hinge	Nickel-plated
40115040YA	Cover cap	Nickel-plated

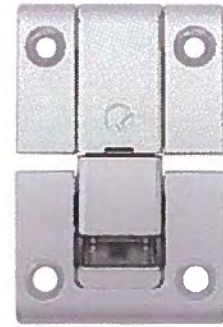

DRILLING PLAN

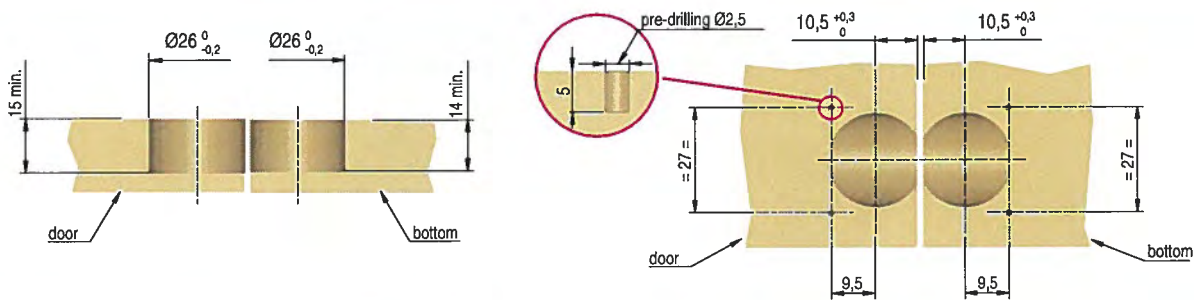

INSTALLATION ON DOOR (MINIMUM THICKNESS 18 MM)

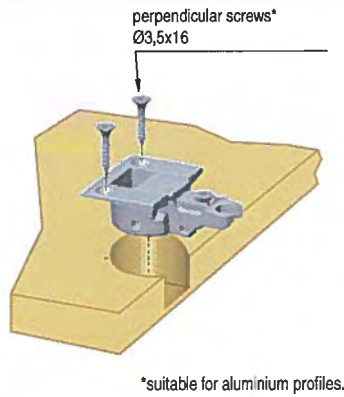

INSTALLATION ON THE BOTTOM (MINIMUM THICKNESS 18 MM)

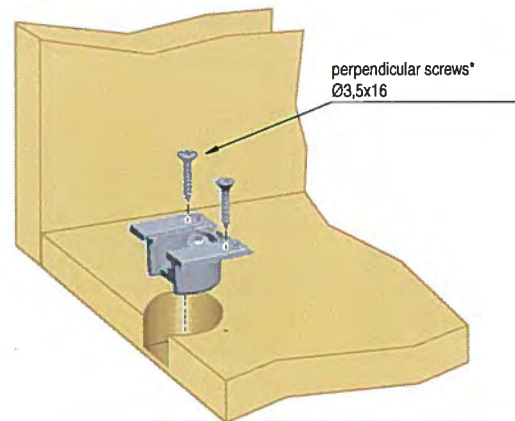

DOOR INSTALLATION



LATERAL ADJUSTMENT 0 ± 1 mm

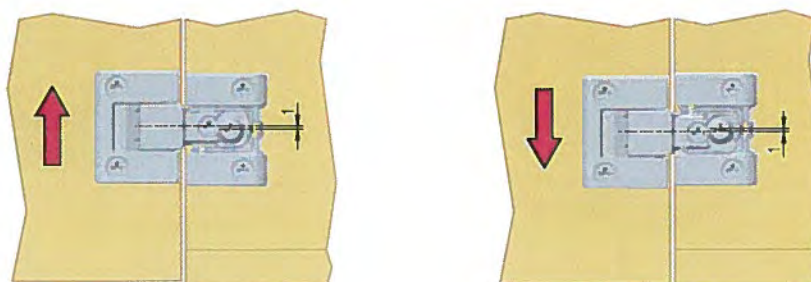

IN-DEPTH ADJUSTMENT 0+2mm

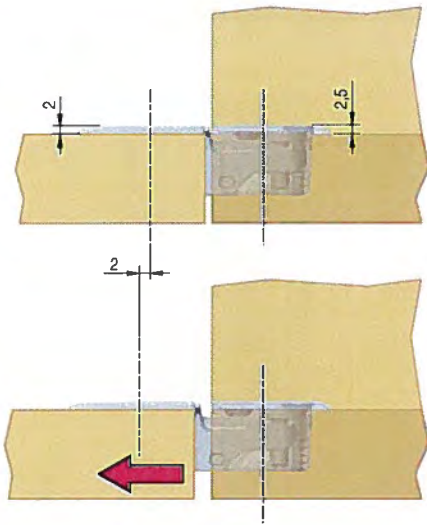

LOCKING

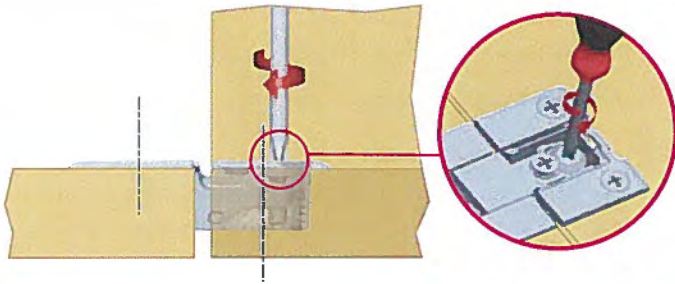

CUSTOMIZED KIMANA COVER CAP

It is possible, upon request, to customize Kimana cover cap with **your company logo** (min. qty 5000 pcs).

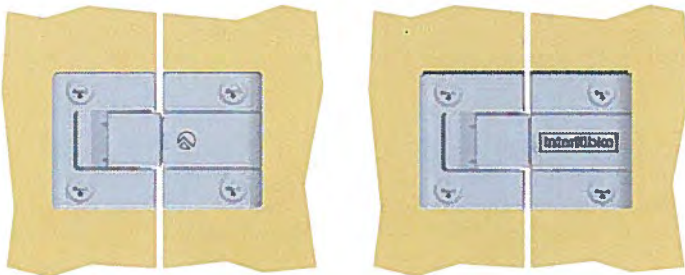

VERTICAL ADJUSTMENT 0+2mm

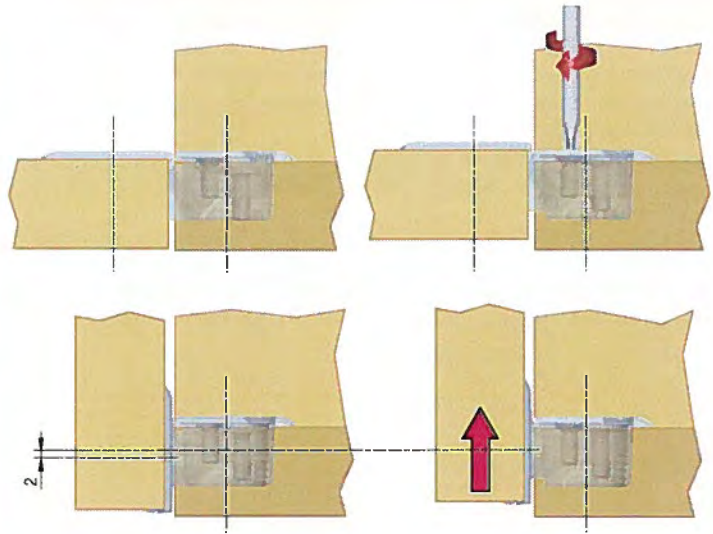

COVER CAP INSERTING

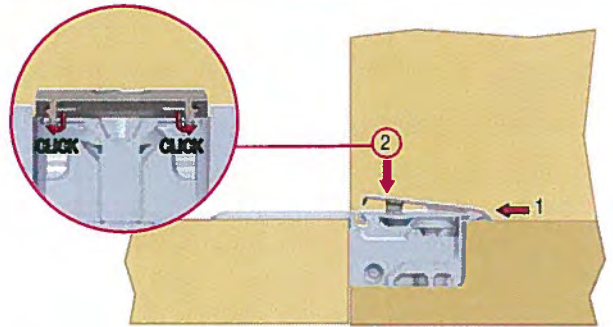

COVER CAP UNINSERTING

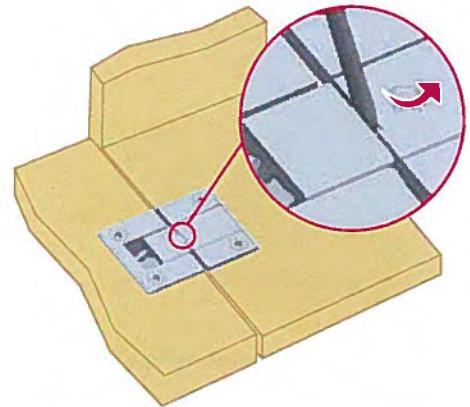

CABINETS IN COLUMN AND PLATFORM

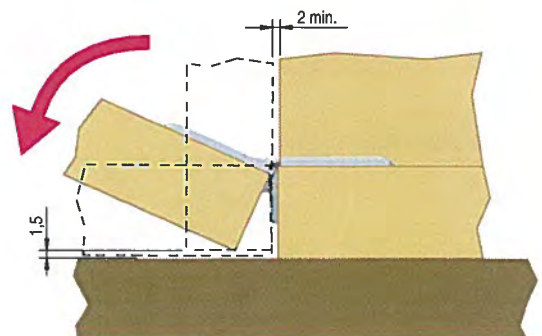
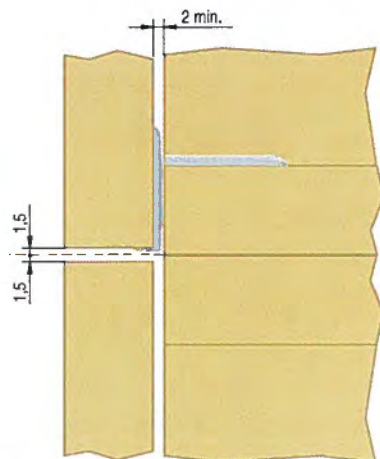
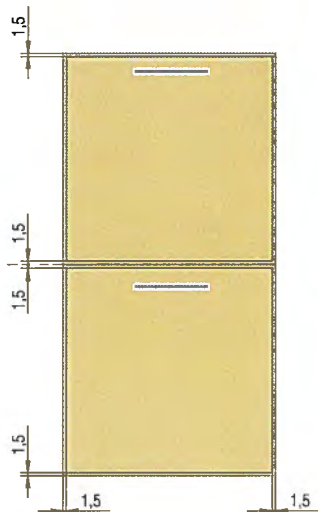

APPLICATIONS WITHOUT ADAPTOR

The applications showed with grey background do not require adjustments for levelling the door.

BOTTOM 18

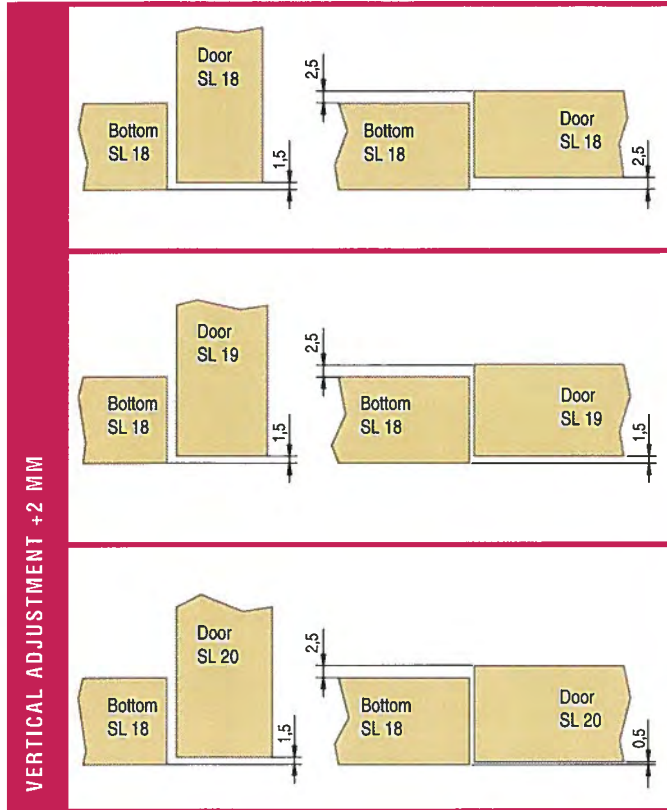

BOTTOM 19

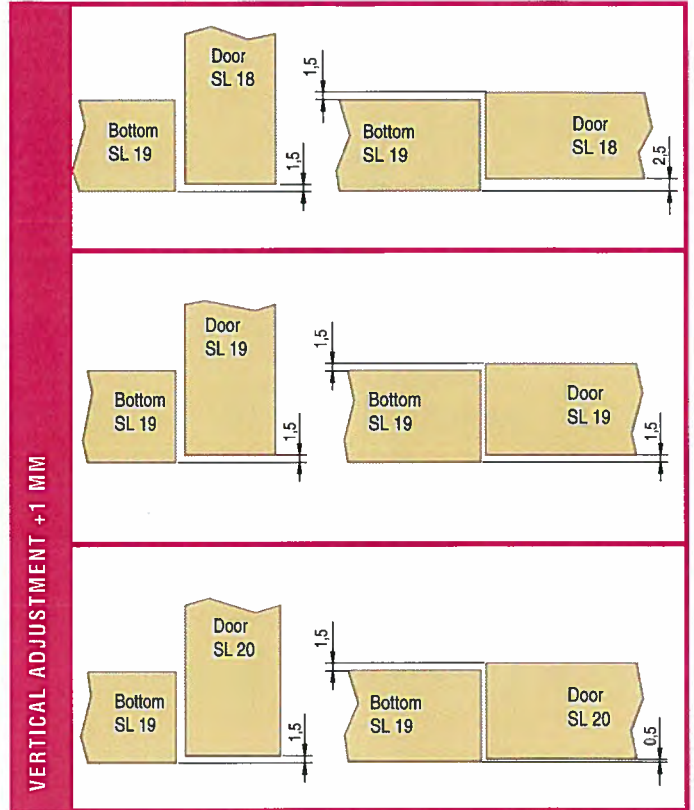

BOTTOM 20

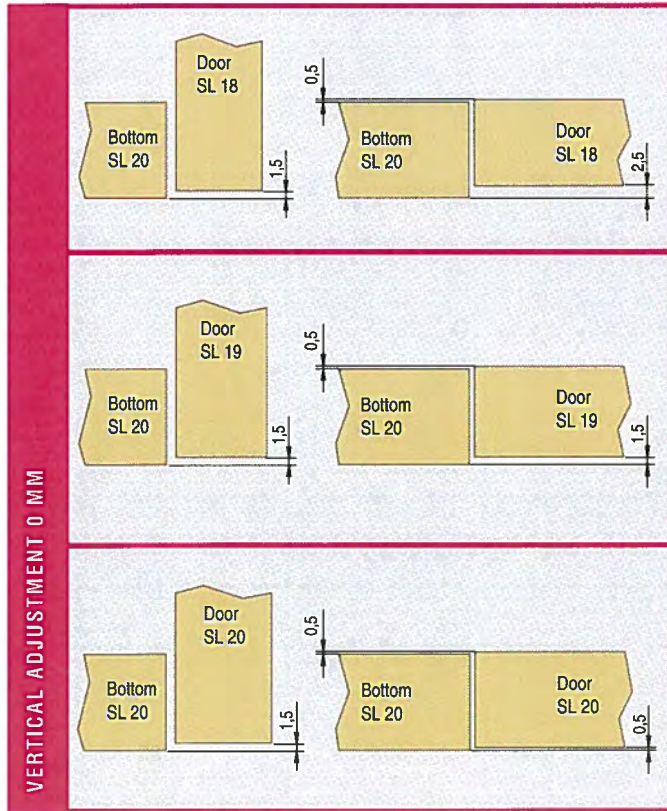

BOTTOM 22

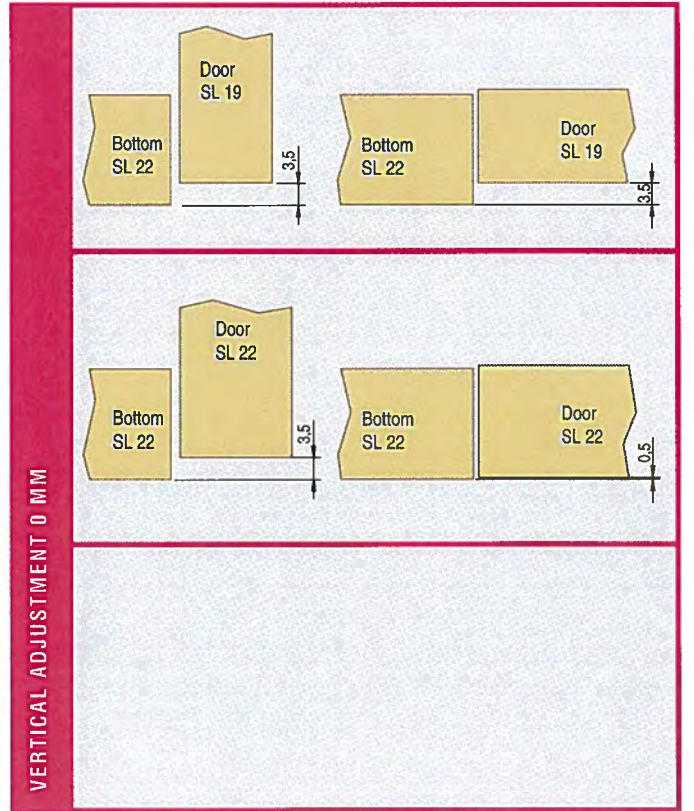

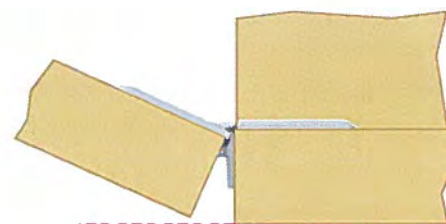
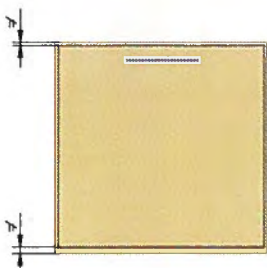
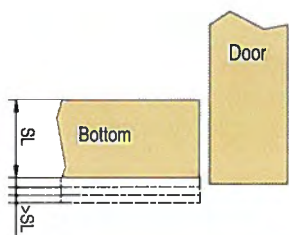
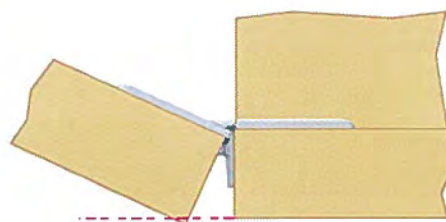
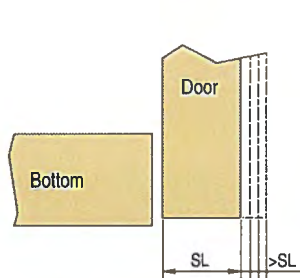

INSTALLMENT WITH ADAPTOR

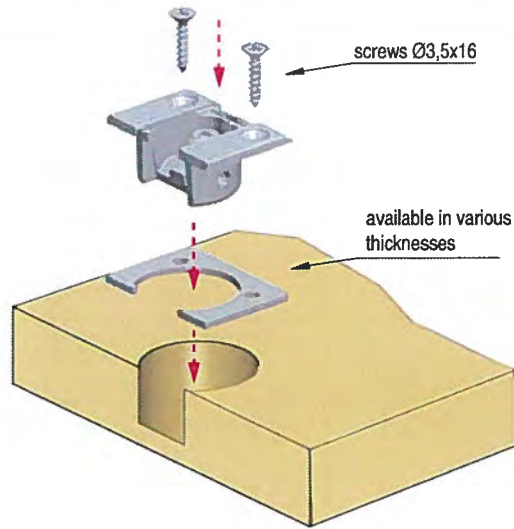

ADAPTORS

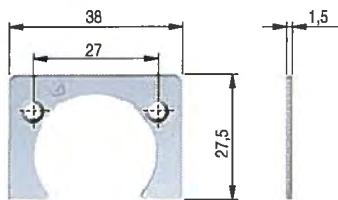

Part. no	Finish
40115320YA	Nickel-plated

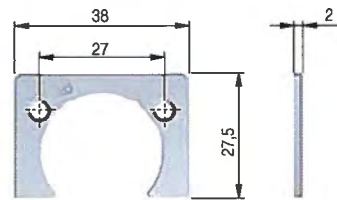

Part. no	Finish
40115340YA	Nickel-plated

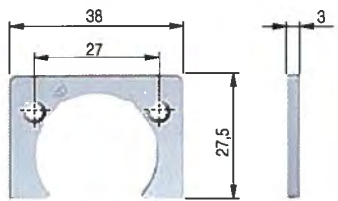

Part. no	Finish
40115360YA	Nickel-plated

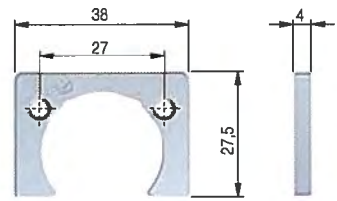

Part. no	Finish
40115400YA	Nickel-plated

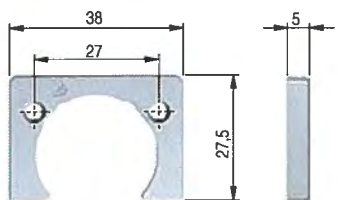

Part. no	Finish
40115440YA	Nickel-plated



APPLICATION WITH ADAPTOR

ADAPTOR FOR BOTTOM PANEL 1,5mm

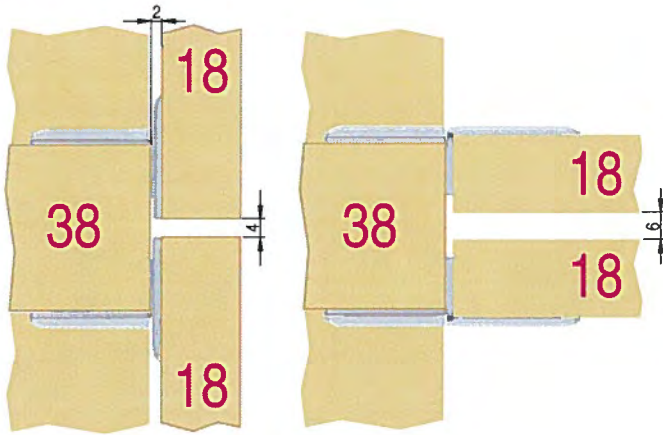

**ADAPTOR FOR DOOR PANEL 1,5mm
ADAPTOR FOR BOTTOM PANEL 4mm**

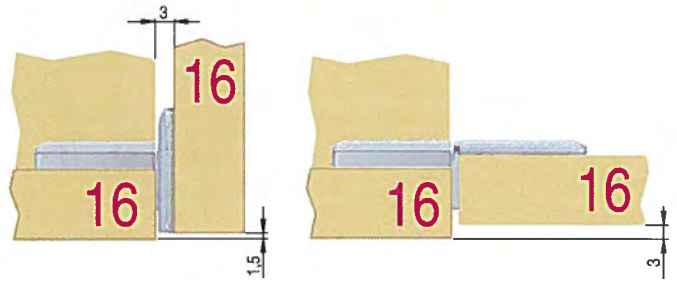

ADAPTOR FOR BOTTOM PANEL 4mm

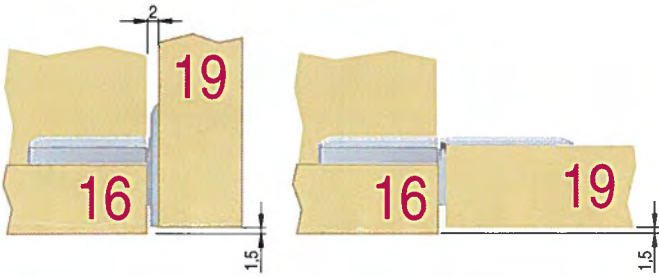

ADAPTOR FOR BOTTOM PANEL 1,5mm

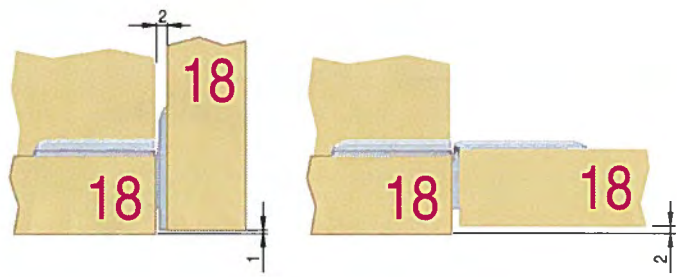

**ADAPTOR FOR BOTTOM PANEL 1,5mm
VERTICAL ADJUSTMENT +2mm**

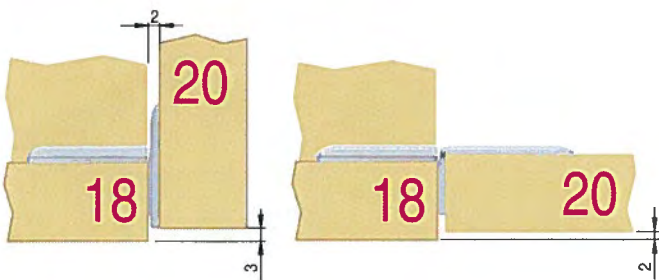

ADAPTOR FOR BOTTOM PANEL 4mm

